

JC-FSD-P

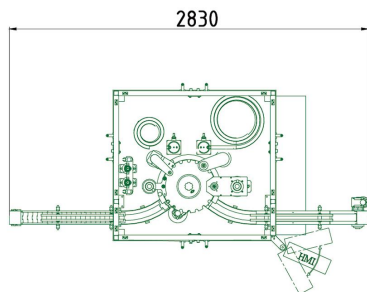

JC-FSX-P

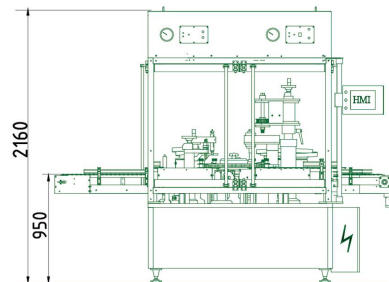
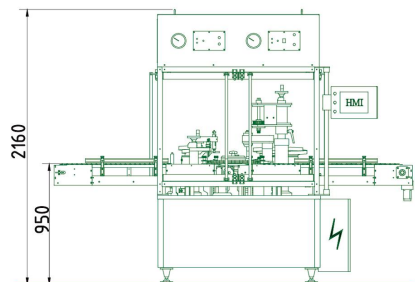
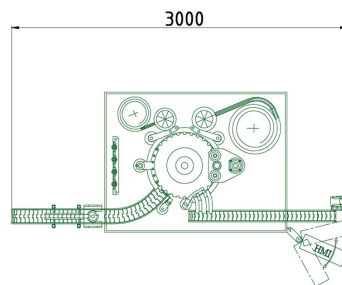

機 型 Model	JC-FSD-P	JC-FSX-P
生產速度 Speed (bpm)	40-50 pcs/min	80-90 pcs/min
使用電源 Power Source (VAC)	220V/380V 50HZ/60HZ	single phase/3 phase
電機功率 Power Consumption (kw)	1.6	2.1
耗 氣 量 Air Consumption (min)	4-6 Kgs x 60 Liter	4-6 Kgs x 72 Liter
機器重量 Machine Weight (kg)	800	950

紀正機械有限公司
Jih Cheng Machinery Technologies Co., LTD
新北市樹林區大安路502號7樓

7F, No.502 Da-An Rd, Shulin Dist., New Taipei City 23849, Taiwan

☎ : +886-2-26758968 ☎ : +886-2-26758229

✉ : sales@jihcheng.com

www.jihcheng.com

上海紀正機械有限公司
Shanghai Jih Cheng Machinery Mfg Co., LTD
上海市閔行區華漕鎮鳴嘉路318號

318, Mingjia Rd., Huacao Town, MinHang Section, ShangHai, China

☎ : +86-21-52265388 ☎ : +86-21-52265658

✉ : sales@jihcheng.com

www.jihcheng.com

自動液體充填內塞外蓋機 Automatic Filling Plugging And Overcapping Machine



紀正機械

Jih Cheng Machinery Tech. Co., Ltd



針對各種小容器所設計，適用於各種小容量之作業。

This machine is specially designed for small containers. It is used in small volume liquid packing operations.



Model : JC-FSD-P series

自動液體充填內塞外蓋機

本機為具有充填、打內塞/栓及鎖外蓋能力的機型，專門使用在小容量的液體包裝作業，尤其對於無菌室的空間硬體設備及能源消耗，頗具節省與精簡之功效；使用PLC邏輯控制器及各種檢測感應裝置，將充填、打內塞/栓及鎖蓋一次完成，完全符合cGMP之標準。適用於眼藥水、水型針劑、化妝品、香精等的自動包裝。

Automatic filling plugging and overcapping machine

This monoblock machine incorporates filling, plug insertion and over cap sealing functions. It is mainly used in small volume liquid packing applications. Being compact, minimal energy consumption, the machine is especially suitable for use inside a sterile area. With PLC and other photoelectric sensor controls, the filling, plug insertion & cap sealing operations are completed meeting cGMP requirement. It is suitable for eye drop, small volume liquid injectable, cosmetics, volatile oil packing applications.

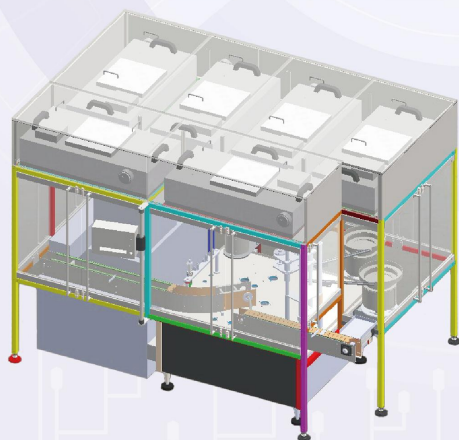

層流罩

加裝層流罩(HEPA)設備，達到無塵空間要求。

Air-Clean booth

With air-clean booth(HEPA) to reach class up to 100,000.



充填

充填缸採用高衛生度的玻璃或不銹鋼316L製品，充填量可以進行個別調整或是全部調整，充填缸傳動採萬向接頭設計，充填運作時順暢，不易卡住。並有電眼監視控制，達到『有瓶充填，無瓶不充填』。

Filling

It adopts high quality hygienic glass material or sus316L for filling pumps. It allows for volume adjustment of one single cylinder or complete set of cylinders. It is using a universal joint for filling cylinder to reach smoothly action and avoid seize up. There is a photo sensor for bottle detection to achieve a goal of Bottle-Fill and No-Bottle-No-Fill.

打內塞

利用機械手臂與機械爪校正瓶口，能準確的將內塞/內栓打入瓶子。

Plug insert

By using a mechanical arm with a jaw will allow the machine to insert the plug precisely into the bottle.

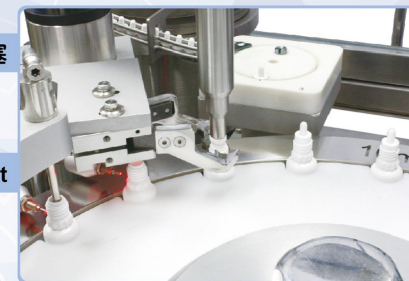

下外蓋

準確的將蓋子由下蓋處送至瓶子上，並利用電眼檢測內塞/內栓，避免無內塞/內栓而供給瓶蓋，造成不良品流出。

Cap placing

Before placing a cap on the top of a bottle, a photo sensor detects the availability of plug. It avoids bottle without plugs.



旋蓋

旋蓋位置上設計有瓶子固定裝置，且旋蓋頭設計有扭力調整裝置，可依不同需求自由調整瓶蓋緊實度；旋蓋頭可依瓶蓋尺寸不同，輕易的進行更換。

Cap sealing

There is a bottle clamping device at the sealing station, while the sealing head equipped with adjustable torqus as needed for individual cap & bottle. It is easy in bottle size change-over for different bottle cap size.

